

LOUISVILLE FREE PUBLIC LIBRARY MIDDLETOWN BRANCH

Project Location:

Louisville, Kentucky

Project Owner:

Louisville Free Public Library

Project Category:

ENGAGE - Public

Project Type:

Renovation

Specific Use of Building:

Public Library

Building Area: (s.f.)

5,317 s.f.

Date of Completion:

November, 2021

Program Summary:

Renovate a former interior design showroom into a progressive public library, without being able to alter the exterior envelope

Integrate early childhood tactile, visually engaging, and active play features

Reuse as much of the existing building structure and skin as possible

Program Statement:

This new branch replaces a space nearly twice as large, yet needed to approximate the same level of service. The redesign focused on maximizing collection space while carefully integrating a variety of reading and meeting space that would resonate with patrons.

The solution sought to play on the existing building geometry of arched clerestory windows and gabled roofs by vaulting the main collection space. The resulting, boomerang-like ceiling, maximizes the spread of daylight, integrates reveals for efficient collection lighting, and visually unifies the two public reading rooms across the main entrance and service point. Bright, colorful carpet breaks down zones, and brings life to a very small space.

A children's activity wall and play space animate the youth collection, and provide engaging elements across all age groups. The climbing and reading niche illustrates a next level of discovery that is obscured at entry, but reveals itself upon closer inspection, and especially from a shorter, child's eye perspective. Textured metal and marker glass clad the few opaque walls, offering greater durability, practical functionality, and helps the space feel larger than it actually is. Staff workspace is ideally arranged to minimize travel distances and support a variety of tasks.

Deep collaboration with the library leaders generated the final layout and detailing, and facilitated the integration of re purposed shelving to minimize project costs. Cleanly detailed, purpose-built millwork, expressive flooring, and colorful furniture play off the charismatic, hybrid-custom fabricated lighting to unify the interior experience. This project imbues a downtrodden structure with a vibrant experience that has resonated with its community. Every detail was carefully crafted to deliver as much experiential variety and value as the previous, much larger facility.

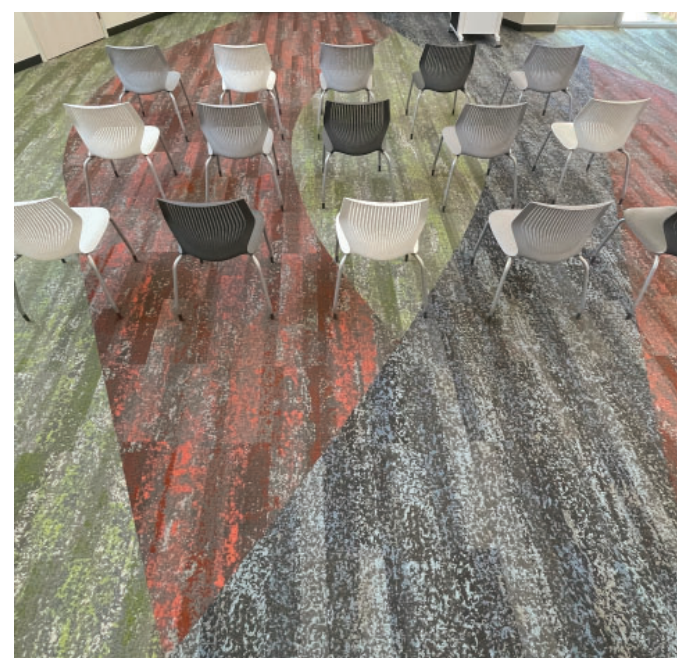

FLOORING DETAIL



PERIMETER STACKS

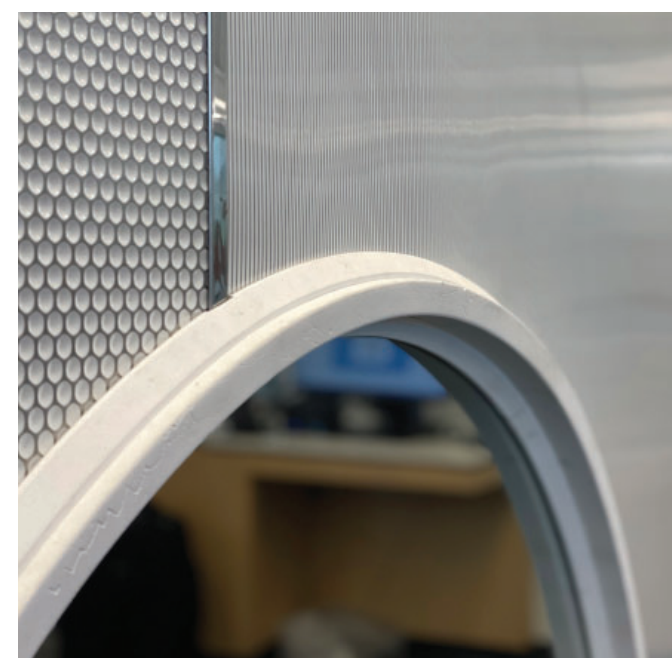

WALL DETAIL

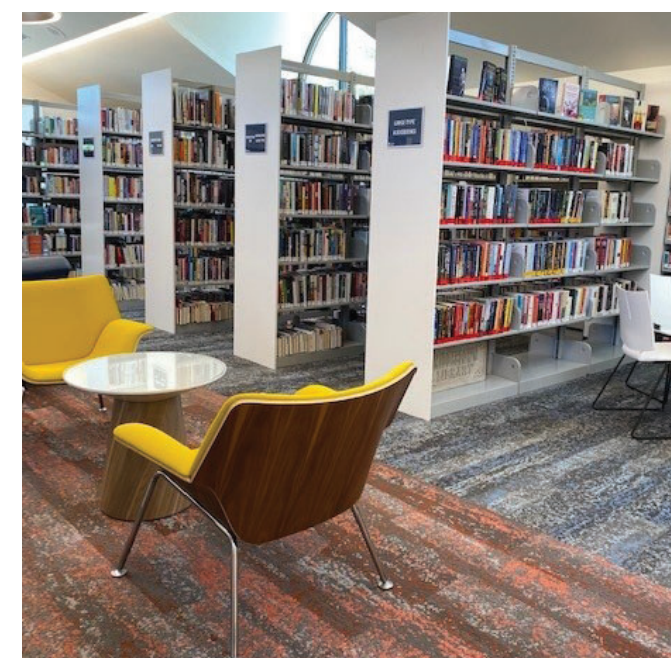

VARIETY OF SEATING

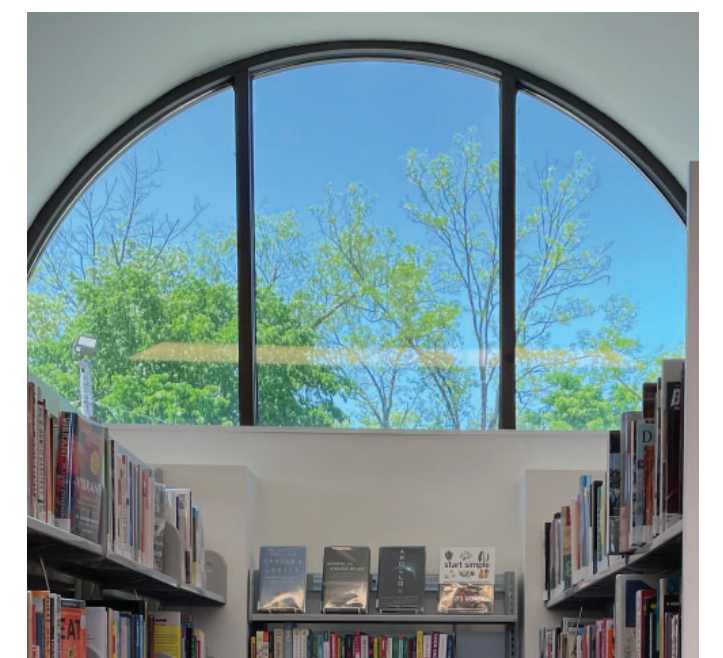

DAYLIGHT



- 1 PROJECT SITE
- 2 RETAIL
- 3 COFFEE SHOP
- 4 HIGH SCHOOL

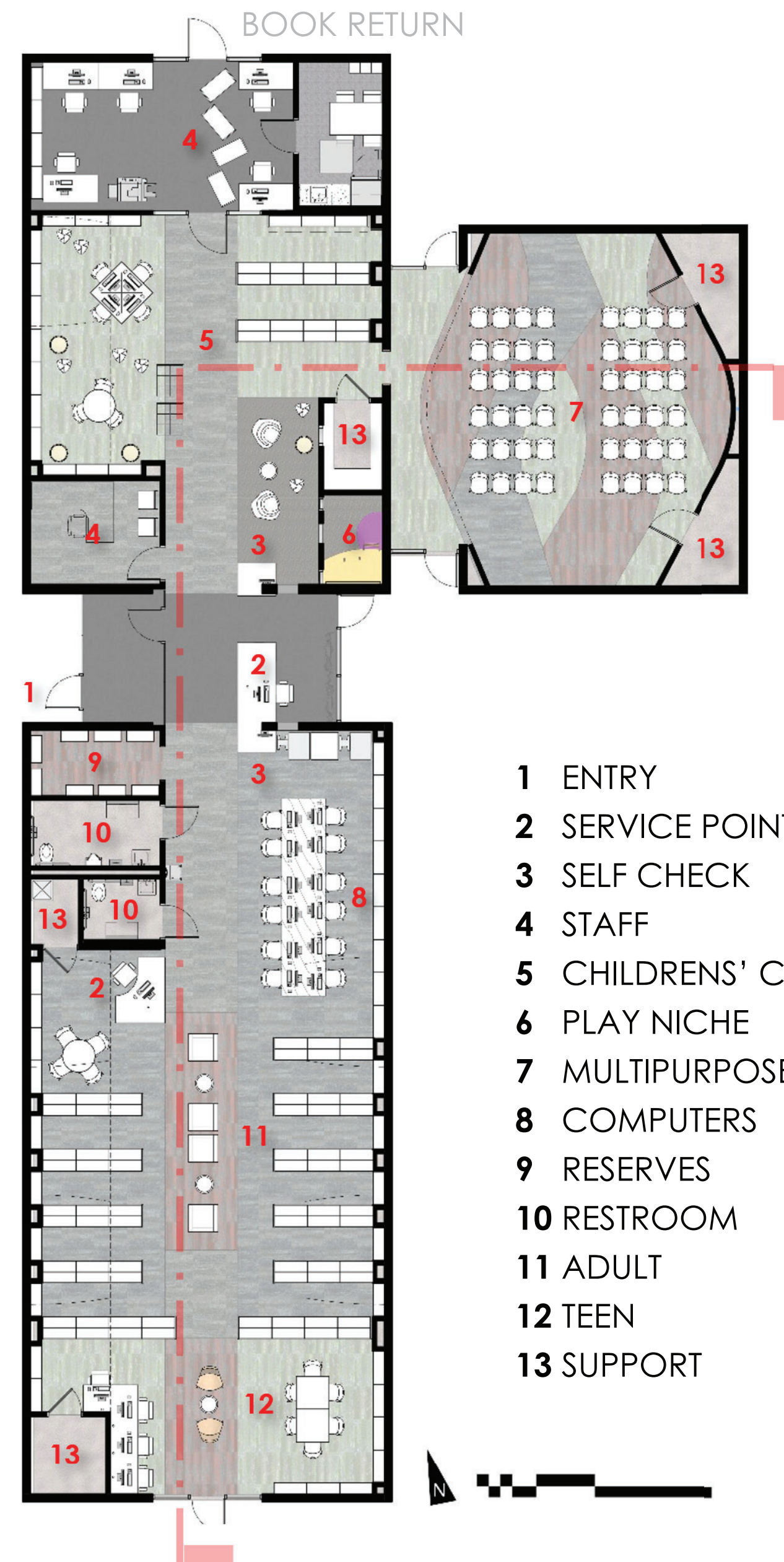

- 1 ENTRY
- 2 SERVICE POINT
- 3 SELF CHECK
- 4 STAFF
- 5 CHILDRENS' COLLECTION
- 6 PLAY NICHE
- 7 MULTIPURPOSE
- 8 COMPUTERS
- 9 RESERVES
- 10 RESTROOM
- 11 ADULT
- 12 TEEN
- 13 SUPPORT



SITE AERIAL & FLOOR PLAN | CONCISE LAYOUT CENTERED ON EFFICIENT CIRCULATION



- 1 ENTRY
- 2 SERVICE POINT
- 3 SELF CHECK
- 4 CHILDRENS' COLLECTION
- 5 PLAY NICHE
- 6 MULTIPURPOSE
- 7 COMPUTERS
- 8 ADULT
- 9 TEEN
- 10 SUPPORT

SECTION RENDERING | ARCHED EXISTING WINDOWS, NEW DORMER SUPPORT STRUCTURE & EXISTING ROOF TRUSSES INSPIRED THE RENOVATION FORM & FINISHES



SERVICE POINT | FRONTING VESTIBULE, LOOKING SOUTH TO ADULT AND TEEN



TEEN | PLACE OF OWNERSHIP WITH AGE APPROPRIATE FURNITURE



PUBLIC COMPUTERS | FACE-OUT NEW MATERIALS ANIMATE THE BACKDROP



CHILDREN'S COLLECTION | EASILY REARRANGED FURNISHINGS ARE ENVELOPED BY THE MATERIALS



CHILDREN'S READING | ACTIVE AND READILY ADAPTABLE ZONE ANIMATED BY THE MAGNETIC, TACTILE WALL AND IRIDESCENT NICHE PORTHOLES



CHILDREN'S NICHE | UNEXPECTED, PLAYFUL, ACCESSIBLE, TACTILE, AND KID-SIZED



COMMUNITY ROOM | ALTERNATIVE INTERPRETATION OF THE GEOMETRIC PARTI, WITH SUBTLE CHANGES IN DRYWALL TEXTURES DEFERRING TO AN EVOCATIVE FLOORING PATTERN



FLEX ZONES | FLOORING AND LIGHTING DELINEATE CIRCULATION FROM FURNITURE ZONES



CHOREOGRAPHED, ORGANIC ORGANIZER | THE SINUOUSLY FLOWING
CENTRAL LIGHTING REINFORCES INTERIOR PROGRAMMING AS IT DEFINITELY
UNIFIES THE TWO BUILDINGS ACROSS THE ENTRANCE ZONE.